

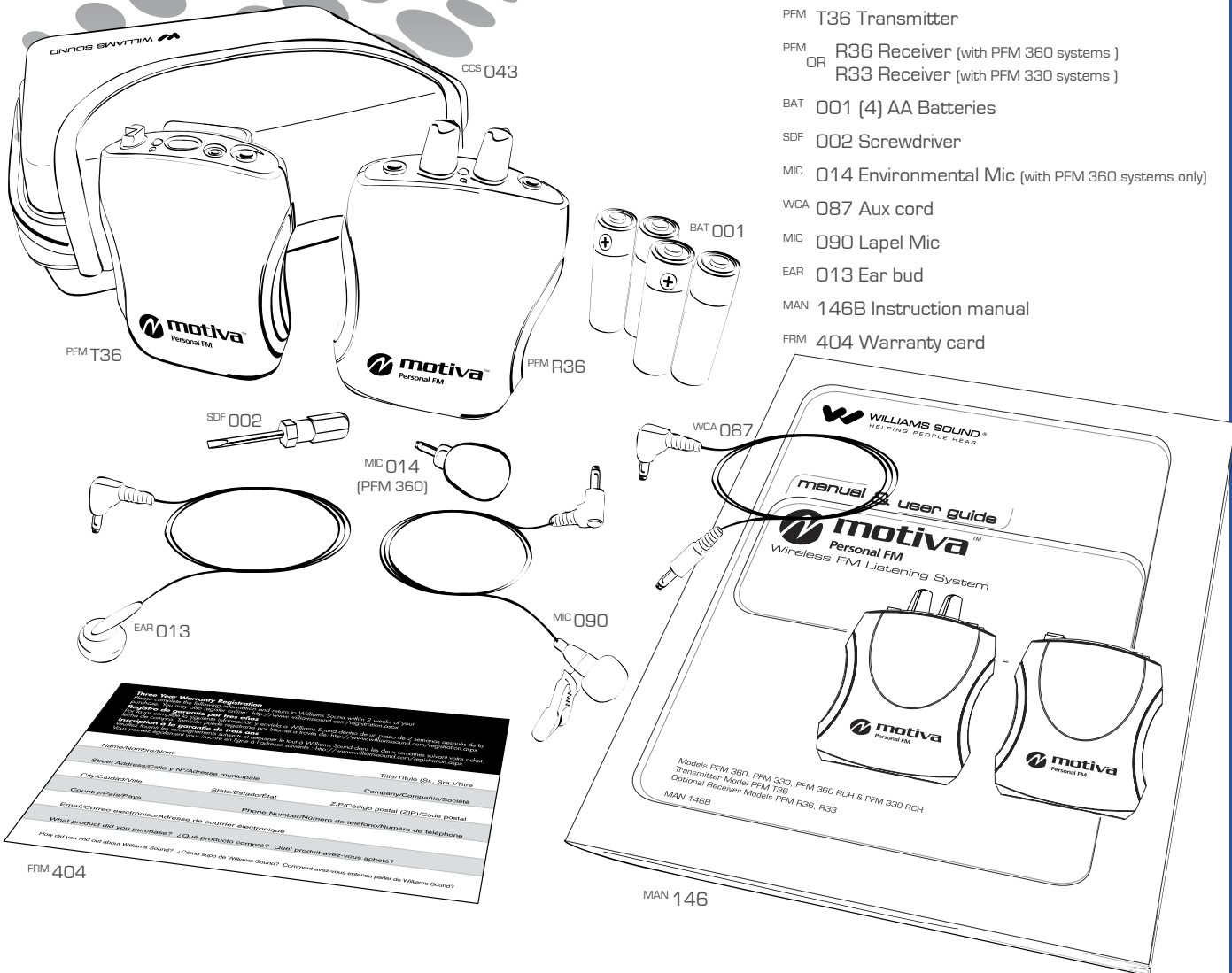

motiva™

Personal FM

quick setup guide



contents

- CCS 043 Carry case
- PFM T36 Transmitter
- PFM R36 Receiver (with PFM 360 systems)
OR R33 Receiver (with PFM 330 systems)
- BAT 001 [4] AA Batteries
- SDF 002 Screwdriver
- MIC 014 Environmental Mic (with PFM 360 systems only)
- WCA 087 Aux cord
- MIC 090 Lapel Mic
- EAR 013 Ear bud
- MAN 146B Instruction manual
- FRM 404 Warranty card

FRM 404

MAN 146

1 install batteries.

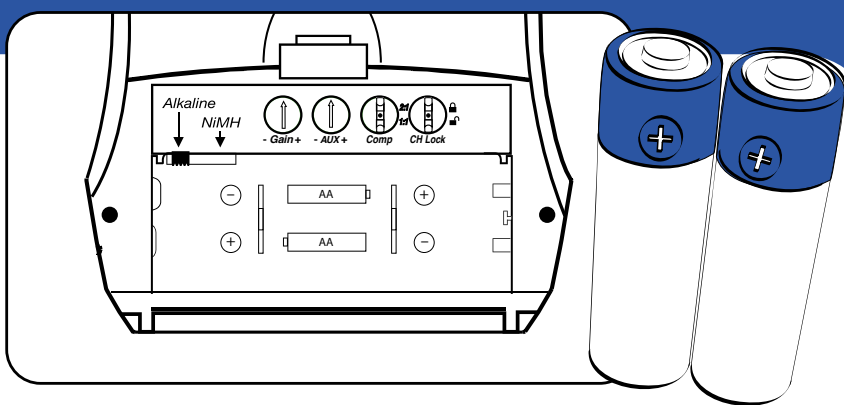

2 install basic components.

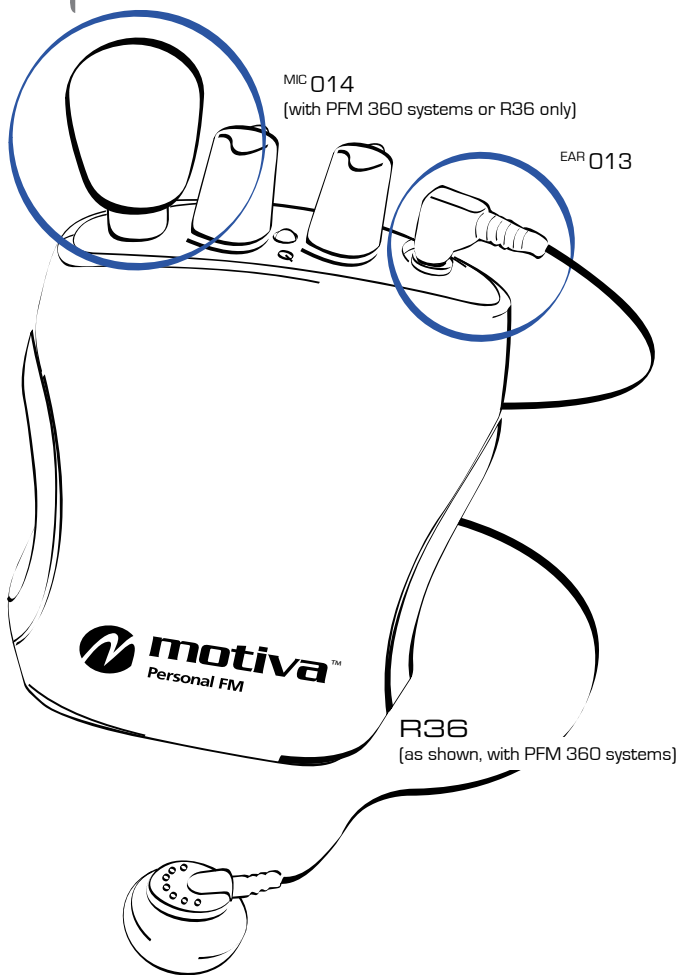
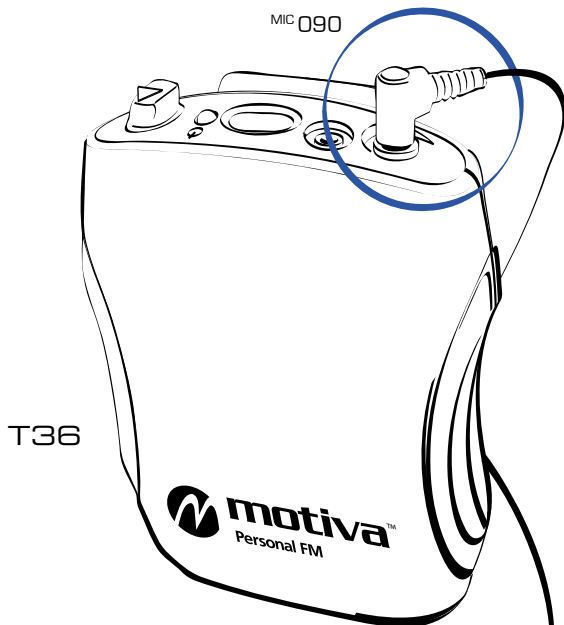

Note: MIC 014 cannot be used in T36 as this cord is the transmitter antenna

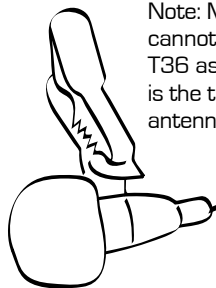

3 turn power on.

