

The Equalizer

Model: K-EQ40



INSTRUCTION MANUAL

2nd Edition 2006

INTRODUCTION

Thank you for purchasing the new Krown Equalizer 40 (K-EQ40) amplified telephone. This phone has been designed for those individuals with mild to moderate hearing loss. The K-EQ40 is designed to control the volume of the phone as well as the frequencies that best fit your hearing. The K-EQ40 has three pitch control buttons allowing you to customize the phone to your desire. The equalizer is set at 600 Hz, 1.2 KHz and 2.4 KHz.

The K-EQ40 is designed with unique feature to protect the hearing in your family. It has one-touch button that automatically resets the equalizer to normal level once the phone is hung up. It helps to protect your family from being exposed to dangerous sound levels.

Please read this manual very carefully before using your K-EQ40 and keep it for future reference. Staple the sales receipt to this booklet for easy access in the event you need to contact Krown Manufacturing for any warranty issues or questions about your purchase.

If you have any questions about our Krown Equalizer 40 that were not covered in this manual, please contact the Krown technical staff at 1-800-366-9950.

The Equalizer | Instructions | 2nd Edition | October 2006

Krown Manufacturing, Inc.

3408 Indale Road, Fort Worth TX 76116

Voice: (817) 738-2485, TTY: (817) 738-8993, Fax: (817) 738-1970

E-mail: info@KrownMfg.com, web site: www.KrownMfg.com

We have designed the Equalizer 40 to conform to the federal regulations and you can connect it to most telephone lines. However, each device you connect to the phone line draws power from the phone line. This power draw is the device's Ringer Equivalence Number, or REN. The REN is on the bottom of your phone.

If you are using more than one phone or other device on the line, add up all the REN numbers. If the total is more than five (or three in rural areas) your phones may not ring. If your phone is not ringing, remove one of the devices from the line.

If your phone causes problems on the phone line, the phone company can disconnect your service. The phone company tries to notify you in advance. If advance notice is not practical, the phone company will notify you as soon as possible and will advise you of your right to file a complaint with the FCC.

The phone company can also make changes to its lines, equipment, operations, or procedures that could affect your phone's operation. The phone company notifies you in advance, so you can take the necessary steps to prevent interruption of your phones service.

FCC STATEMENT

Your telephone complies with Part 68 of FCC Rules. You must, upon request, provide the FCC registration number and the REN to your telephone company. These numbers are on the bottom of your phone.

THE EQUALIZER K-EQ40

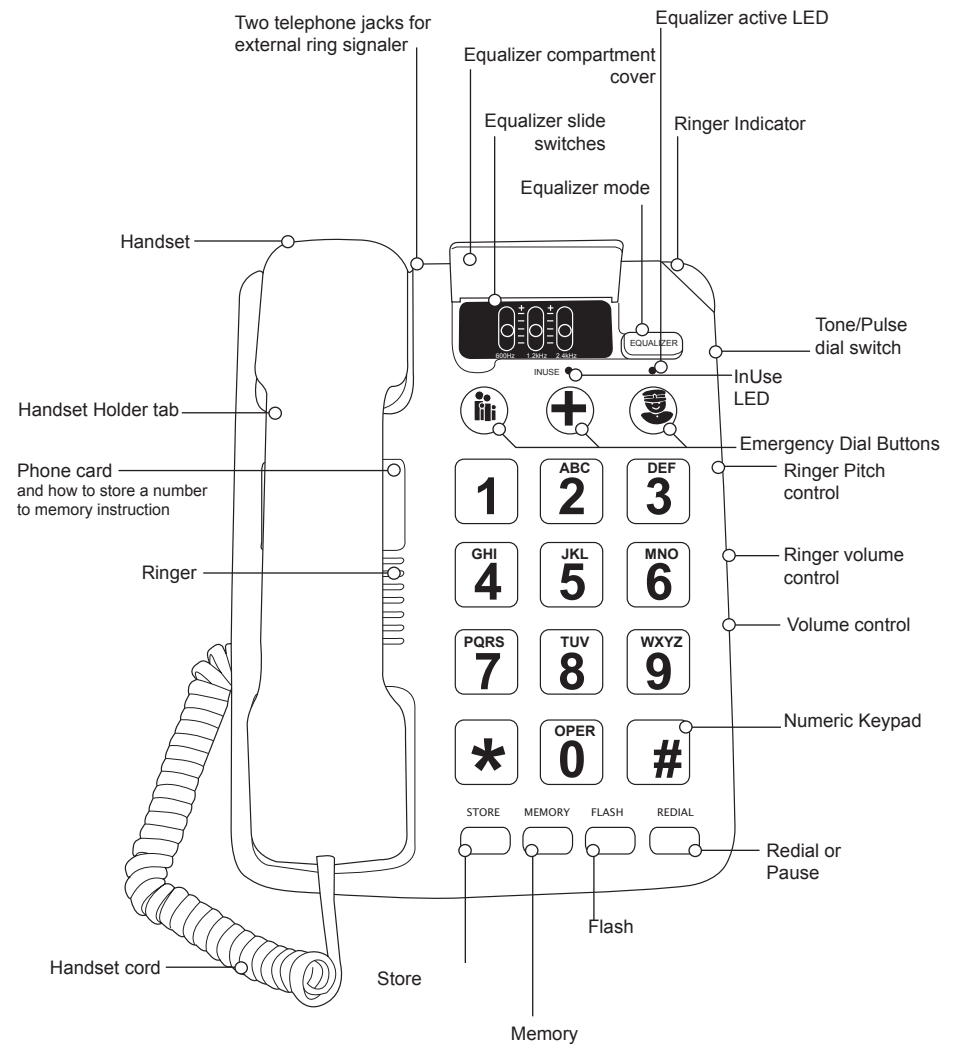

FOR DESKTOP USE

1. Turn the phone upside down. Insert the two smaller tabs into the slots (see Figure 1) and then press down on the bracket's top edge until the two larger tabs snap into place.
2. Plug one end of the handset cord into the jack on the handset and the other end to the jack on the bottom of the base unit.
3. Press the cord into the channel provided to keep it out of the way.
4. Plug one end of the supplied long telephone line cord into the jack on the back of the base. Plug the other end into the wall phone jack.

Note: If the large tabs do not snap in easily, push slightly against the tabs while you press down on the bracket.

Figure 1

For desktop use

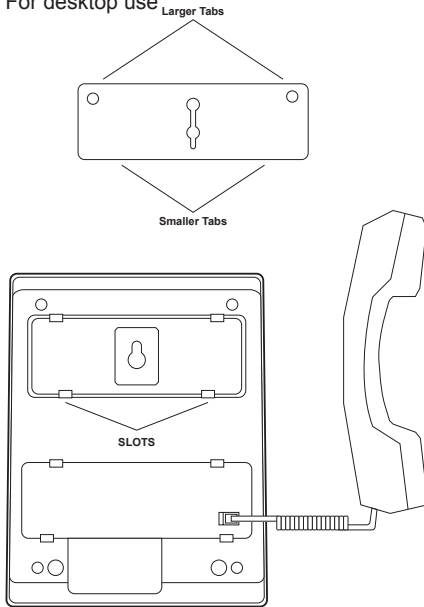
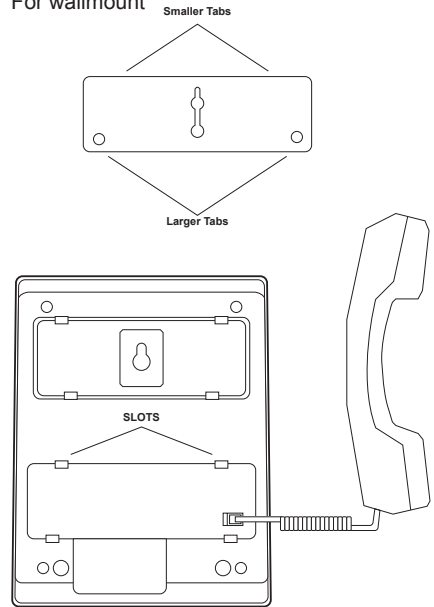

Figure 2

For wallmount



FOR MOUNTING ON A WALL (Figure 2 & 3)

1. Plug one end of the handset cord into the jack on the handset and the other end into the jack on the back of the base unit.
2. Press the cord into the channel provided to keep it out of the way.
3. Turn the phone upside down. Inset the two smaller tabs into the slots as shown in Figure 2, then press down on the bracket's bottom edge until the two larger tabs snap into place.

Note: If the large tabs do not snap in easily, push slightly against the tabs while you press down on the bracket..

4. Plug one end of the supplied short telephone line cord into the jack on the back of the base.
5. Plug the other end of the cord into the wall plate.
6. Fit the hole slots over the wall plate studs and slide the phone downward to secure it. (Figure 3)
7. Before you hang up the phone's handset, slide up the handset holder to remove it (see Figure 4). Turn over the handset holder so its tabbed edge faces up, and then slide it back down into its slot.

Figure 3

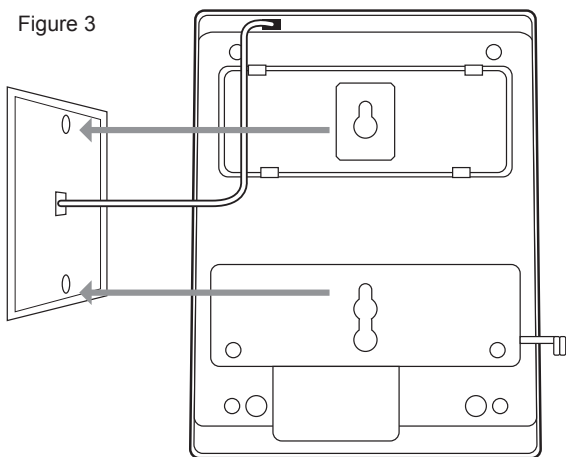
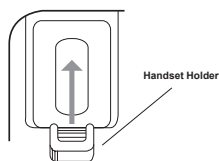

Figure 4



THE EQUALIZER FEATURES

1. Volume Control

Slide the HANDSET VOLUME (it is located on the right side of the base) to a comfortable listening level.

2. Ringer Volume Control

Set the ringer volume, located on the right side, by sliding RINGER to HI (high) to amplify the ringer, or to LO (low) for a softer ring. To turn off the ringer, set it to OFF. You can still make and receive calls with the ringer off.

3. Ringer Pitch Control

To adjust the pitch of the ringer set PITCH to 1 (low frequency), 2 (medium frequency), or 3 (high frequency) located on the right side of the base..

4. Tone Pulse Control Switch

Set TONE/PULSE, located on the right side of the base to TONE (tone) or PULSE (pulse) to match the type of service you have.

5. Ringer Indicator

The red ring indicator, located in the top right corner will flash when the phone rings. It will flash even if the ringer is turned off.

6. Redial / Pause

Press REDIAL to dial the last number dialed (up to a 32 digit number). This button is also used to insert a pause into a string of number stored in memory.

7. Flash

Press FLASH to perform the switchhook operation for special services, such as Call Waiting. If you do not currently have that service with your local telephone company, pressing FLASH may disconnect your call. To obtain this service, contact your local telephone company for subscription information regarding this service.

Note: The redial memory does not store a FLASH entry or any digits entered before you press FLASH.

8. Using the equalizer

The phone's 3-band equalizer boosts the sound of three frequency ranges (600 Hz, 1.2 kHz, 2.4 kHz) to compensate for the ear's limited sensitivity in these ranges. To adjust the settings, open the cover next to the EQUALIZER button (it reads Krown Manufacturing). Slide each switch toward "+" to increase or amplify sound, or toward "-" to decrease the sound within that specific range.

Figure 5

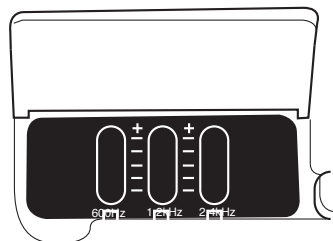

To turn on the equalizer, press **EQUALIZER** button after you pick up the handset, or at any time during a call. The indicator below the button lights up to indicate the equalizer is activated. To turn off the equalizer during a call, press **EQUALIZER** button again. The indicator light will turn off when the equalizer is not being used. The equalizer will turn off automatically once the phone has been hung up.

- 9. IN USE LED:** Indicates the telephone line is in use by this telephone or other device on the same line.

MEMORY DIALING



The Equalizer has three emergency buttons and ten speed dial numbers.

1. Storing a Number

- Lift the handset and press **STORE**.
- Enter the phone number. (16 digits maximum)

Note: To enter a pause of about three seconds after an access code (9 for example), enter the access code. Press **REDIAL**. Enter the reset of numbers.

c. Press **MEMORY**

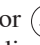
- d. Press , , or  to store emergency numbers (for ambulance, fire department, or police) or press one digit (0-9) to store other speed dial numbers.

For example, to store the a number in memory location 1:

- Lift the handset and press **STORE**
- Enter a number for example Krown Manufacturing “817-738-2485”
- Press **MEMORY**
- Press number [1]. “817-738-2485” is now stored as speed dial number 1

2. Dialing a Stored Number

To dial a number stored in an emergency memory location (the buttons with symbols) lift the handset and press , , or .

To dial a number stored in a speed dial memory location, lift the handset and press **MEMORY**, then the desired speed dial memory location (0-9). For example, to dial 817-738-2485, lift the handset and press **MEMORY** then number 1.

Note: If you store an emergency services number (police, fire department, and ambulance) and you want to test the stored number, make the test call during the early morning hours to avoid peak demand periods. Remain on the line to explain the reason for your call.

To enjoy your K-EQ40 for a long period of time, follow these instructions:

- Keep the phone dry. If it gets wet, wipe it dry immediately.
- Use and store the phone only in normal temperature environments.
- Handle the phone gently and carefully. Do not drop it.
- Keep the phone away from dust and dirt.
- Wipe the phone with a damp cloth occasionally to keep it looking new.

Modifying or tampering with the phone's internal components can cause a malfunction and invalidate its warranty. If your phone is not performing as it should, contact the Krown Manufacturing technical department for assistance. If the trouble is affecting the phone lines, the phone company may ask you to disconnect your phone until you have resolved the problem.

SPECIFICATIONS

Amplification	up to 40dB
Physical dimensions	6 1/4" x 8 5/16" x 7/8"
Keypad	13/16" large, high contrast keys
Ringer volume	95dB
Handset	Hearing Aid Compatible
Memory	10 Speed Dial Numbers 3 Emergency Speed Dial Buttons
Connections	2 RJ11 modular jacks to connect to a standard analog phone line or compatible line.
Approval	FCC approved

Krown Manufacturing Inc. Warrants that the Equalizer sold by Krown Manufacturing is free from defects in materials and workmanship under normal use and service for one year. This warranty is applicable only to the original purchaser of the K-EQ40 when accompanied by a sales receipt stating the date of purchase and the name of company from which purchased. This warranty is in lieu and excludes all other warranties, expressed or implied, including any implied warranty of merchantability or fitness and of any obligation on the part of Krown Manufacturing. If the Equalizer shall prove to be defective, then Krown Manufacturing shall either replace or repair the Equalizer at no cost to the original purchaser within one year of the date of purchase. During the one year period you may return the Equalizer to Krown Manufacturing at the following address:

Krown Manufacturing, Inc.
3408 Indale Road, Fort Worth, Texas 76116

Shipping charges are at the customer's expense. Please include a check or money order made out to Krown Manufacturing in the amount of \$10.00 to cover shipping and handling. This warranty does not extend to any Equalizer sold by Krown Manufacturing which has been subjected to misuse, neglect, accident, improper application, improper installation, or any use in violation of the instruction furnished by Krown Manufacturing. This warranty does not extend to or apply to any Equalizer which has been repaired or altered by any persons who have not been expressly approved by Krown Manufacturing.

Krown Manufacturing shall not be liable for any special or consequential damages or for loss or expense directly or indirectly arising from use of the products or any inability to use them either separately or in combination with other equipment or product accessories or from any other cause. This warranty is only applicable to a product purchased through Krown Manufacturing, CompuTTY, or a Krown dealer. Other than as stated herein, there are no other warranties whether by the sample or model, by description or quantity, whether expressed or implied, and there are no implied warranties of fitness for a particular purpose or of merchantability.



3408 Indale Road, Fort Worth, TX 76116

Voice: (817) 738-2485

TTY: (817) 738-8993

Fax: (817) 738-1970

E-mail: info@KrownMfg.com

www.KrownMfg.com