



SERENE®
VQ-500
 Vibrating Alarm
 Dress Watch

Users Manual

Operating Guide
 Thank you for purchasing this product, please keep this manual for future reference

1. Setting The Analog Dial Time

1. Pull dial out and adjust analog time.
2. Push dial back in when done.



2. Digital Time Setting

(For proper alarm operation, the digital time must be set to the same as analog time).

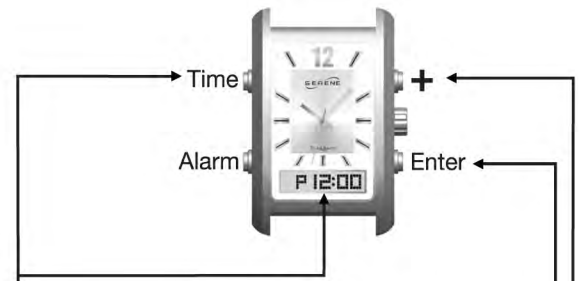

1. Press and hold "Time" button for 2 seconds to see "hour".
2. Press "+" button to change Hour setting (hour blinking; press and hold to change fast)
3. Press "Enter" button to save while "minute" starts blinking.

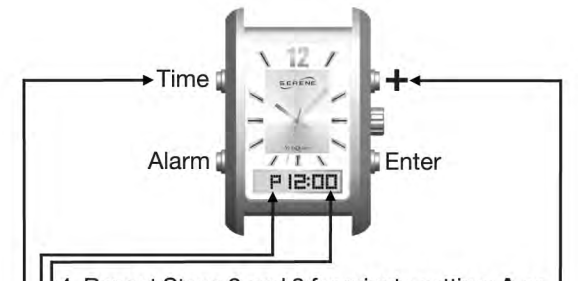

4. Repeat Steps 2 and 3 for minute setting; **A** or **P** should now be blinking.
5. Press "+" button to toggle **A** or **P** (A=AM; P=PM). Press "Enter" to save.
6. Press "Time" button for 2 seconds or wait 15 sec to exit.

3. Change Alarm Time

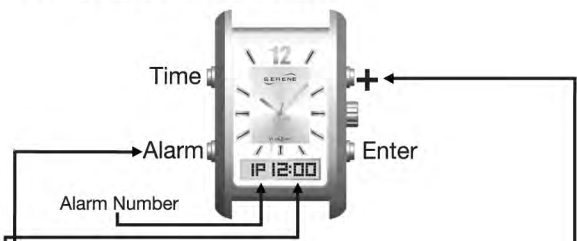

1. Press and hold "Alarm" button for 2 seconds to see first alarm status, press "Enter" to see next alarm.
2. If it is off, press "Alarm" button once so alarm time is shown (ON).
3. Press "+" button to change alarm hour (press and hold to change fast).

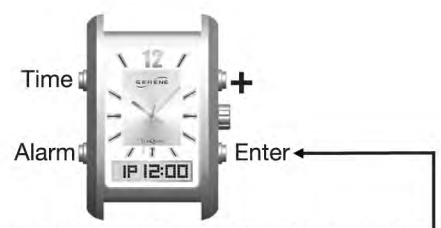

4. Press "Enter" button to save while minute starts blinking.
5. Repeat Steps 3 and 4 for minute setting.
6. Press "+" button to toggle **A** or **P** (A=AM; P=PM). Press "Enter" to save. Alarm number is blinking. **(Note: Alarm is now set and ON. If you do not want it to be on yet, just press "ALARM" to toggle it to off.)**
7. Press "ALARM" button for 2 sec or wait 15 sec to exit.

Alarm Operation:

1. Display normally shows the next alarm "ON" time. However, if all alarms are off, it'll show "OFF".
2. When alarm goes off, the watch will notify you using 6 burst of 2 second vibration.
3. Press any button to stop the vibration while the alarm is going off.
4. After alarms end, the same set alarm will be triggered the same time next day unless readjusted or turned off.

Note: After replacing battery, press & hold all 4 buttons to reset.

4. See And Change Individual Alarm Status(On/Off)

5 alarm status may be viewed and changed. Factory default alarm time is 12:00 PM and they are all set to off. When all 5 alarms are off, the display will be shown as **OFF**.

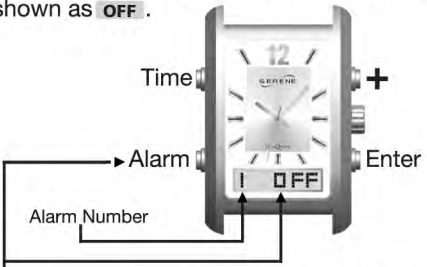

1. Press and hold "Alarm" button for 2 seconds to see first alarm status (ON / OFF). **Note:** Alarm number is blinking.

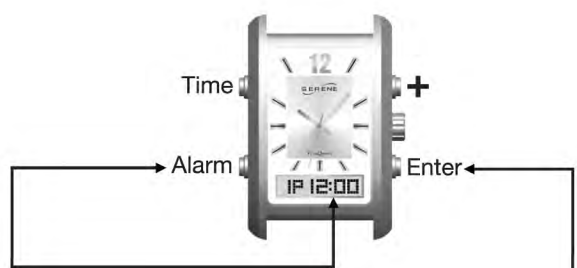

2. Press "Alarm" button to toggle it to ON (or OFF). **1P12:00** Means Alarm 1 is ON and set for 12:00 PM.
3. Press "Enter" button to save and see the next alarm and repeat step 2 if necessary.
4. Press and hold "Alarm" button for 2 sec or wait 15 sec to exit.

5. Warranty service information

Your **VQ-500** comes with one-year limited warranty. We warrant during this warranty period – from the date of purchase to the original consumer – the **VQ-500** is free from defects in materials and workmanship under intended use. In the event that **VQ-500** fails to function properly within one year of the original purchase, due to defects in materials or workmanship, return the unit (freight prepaid) with proof of purchase (sales receipt or packing slip, no exceptions) to Serene Innovations. Serene Innovations will either repair or replace the unit (with a refurbished unit or a unit of equal condition) and return it to you (using UPS/USPS ground shipping) at no cost to you, if the unit is returned within 30 days of purchase. If the unit is returned after 30 days of purchase, but within the warranty period, there will be a warranty handling charge of \$9.95 for each return.

This warranty does not apply to any product that has been accidentally damaged, abused, misused or neglected. Defects or errors caused by unauthorized alterations, repairs, and/or tampering are also not covered by this warranty.

Serene Innovations, Inc.
 14731 Carmenita Road, Norwalk, CA. 90650 Toll Free: 866-376 9271, Fax: 560-483-2087
 Website: www.sereneinnovations.com Email: Customercare@Sereneinnovations.com